



Schwandstrasse 18

6315 Alosen

Telefon: 041 750 64 00

Fax: 041 750 40 94

Mail: info@fenster-nussbaumer.ch

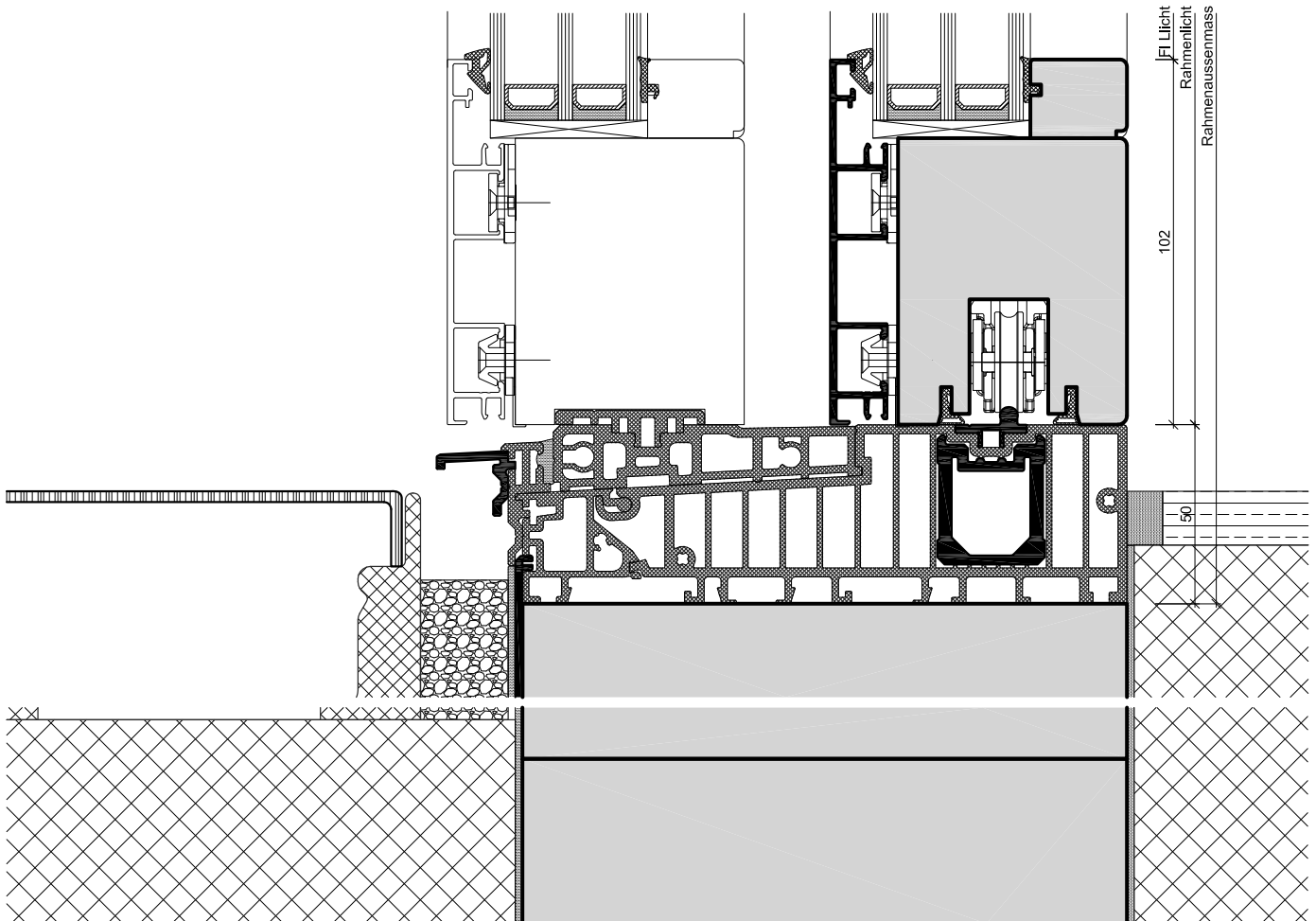
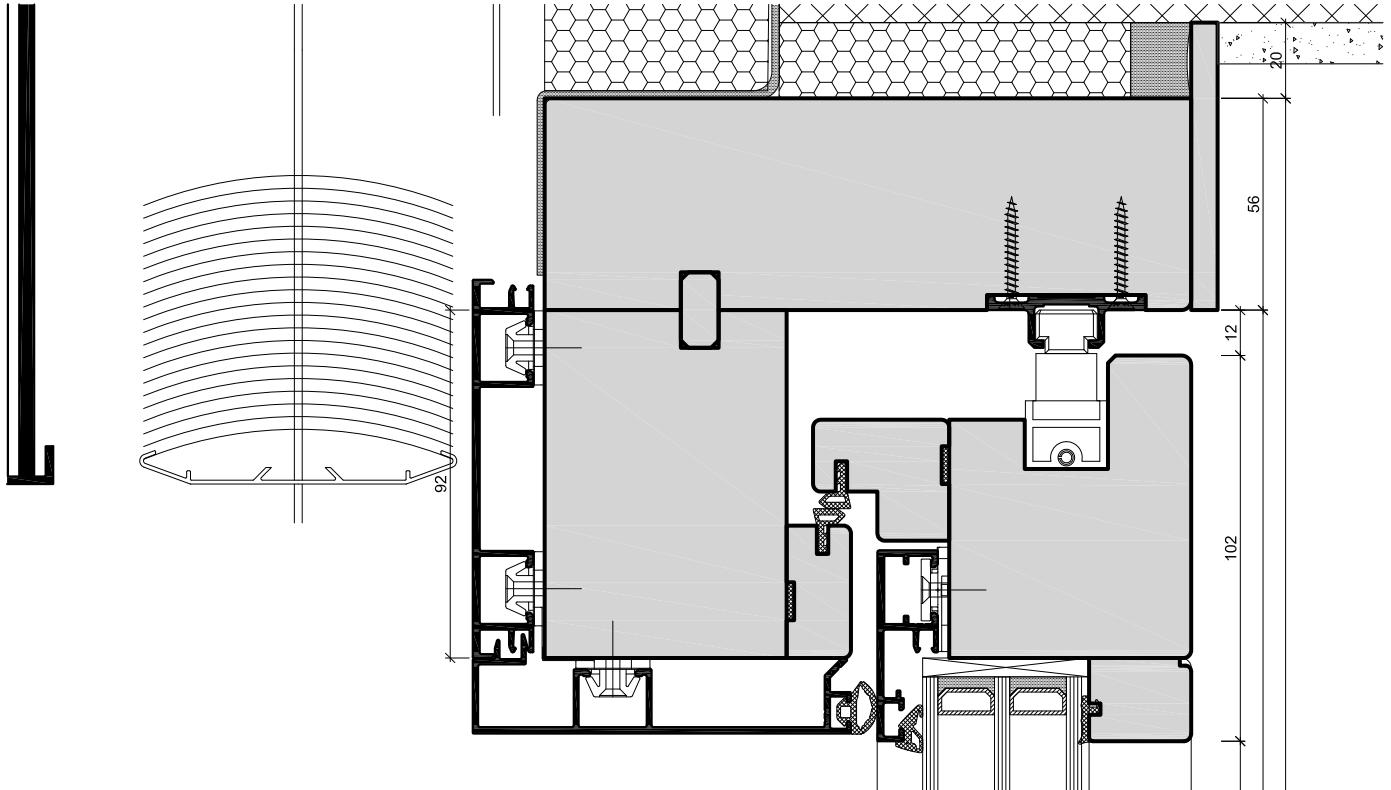



Schwandstrasse 18

6315 Alosen

Telefon: 041 750 64 00

Fax: 041 750 40 94

Mail: info@fenster-nussbaumer.ch

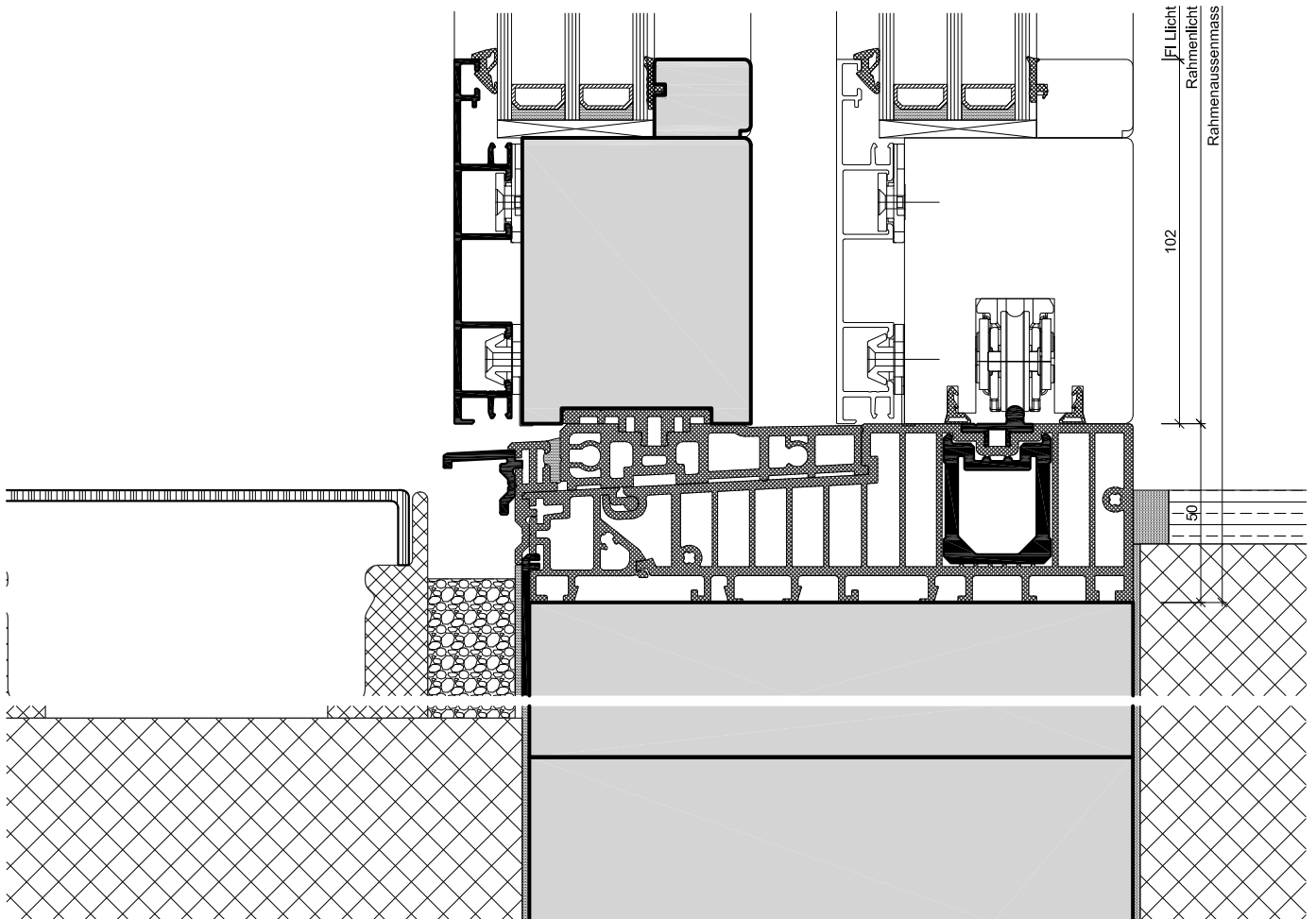
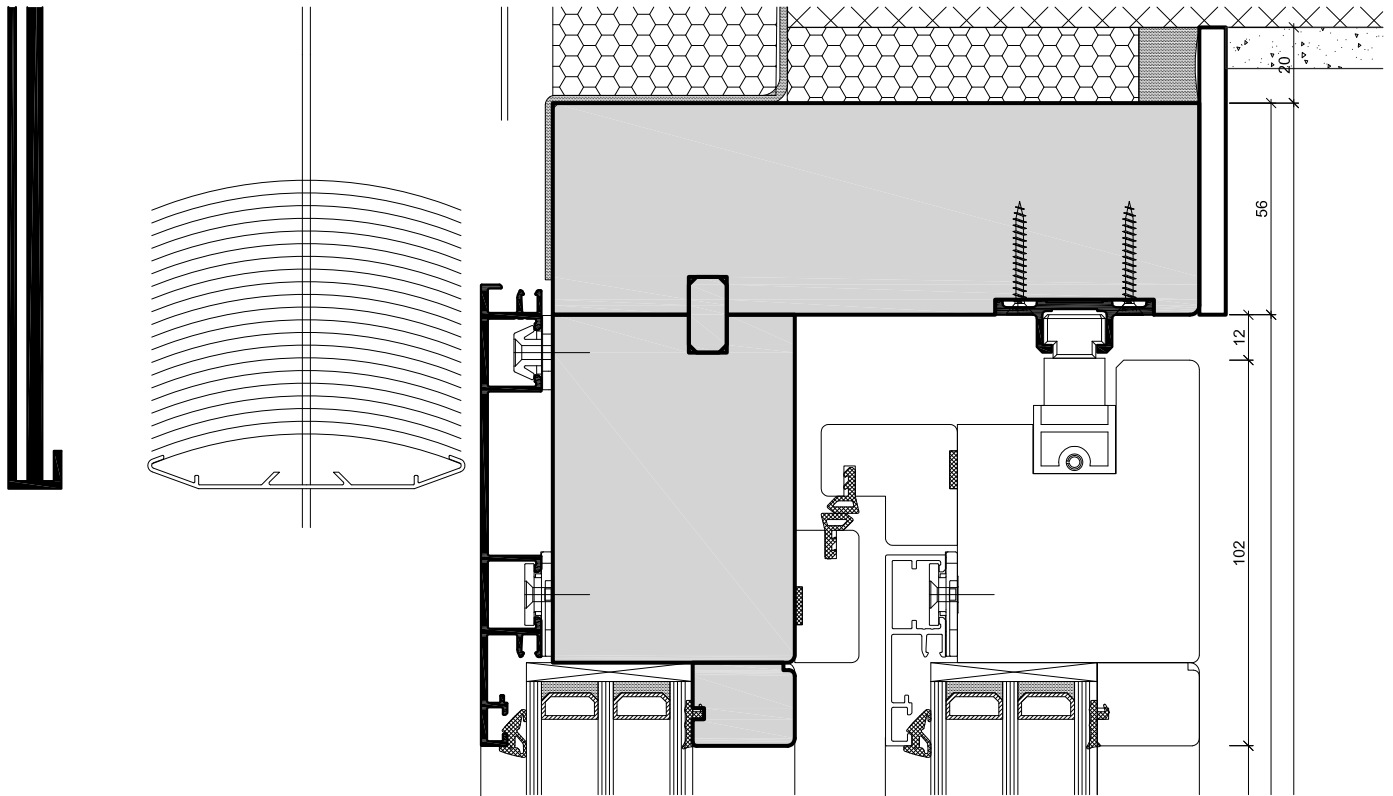



Nussbaumer Fensterbau AG

HM-Fenster Hebschiebetür

Horizontalschnitt

Zeich. 301-401-302

Mst. 1:2

HST Si V m.GL

Datum 21.12.2015

Schwandstrasse 18

6315 Alosen

Telefon: 041 750 64 00



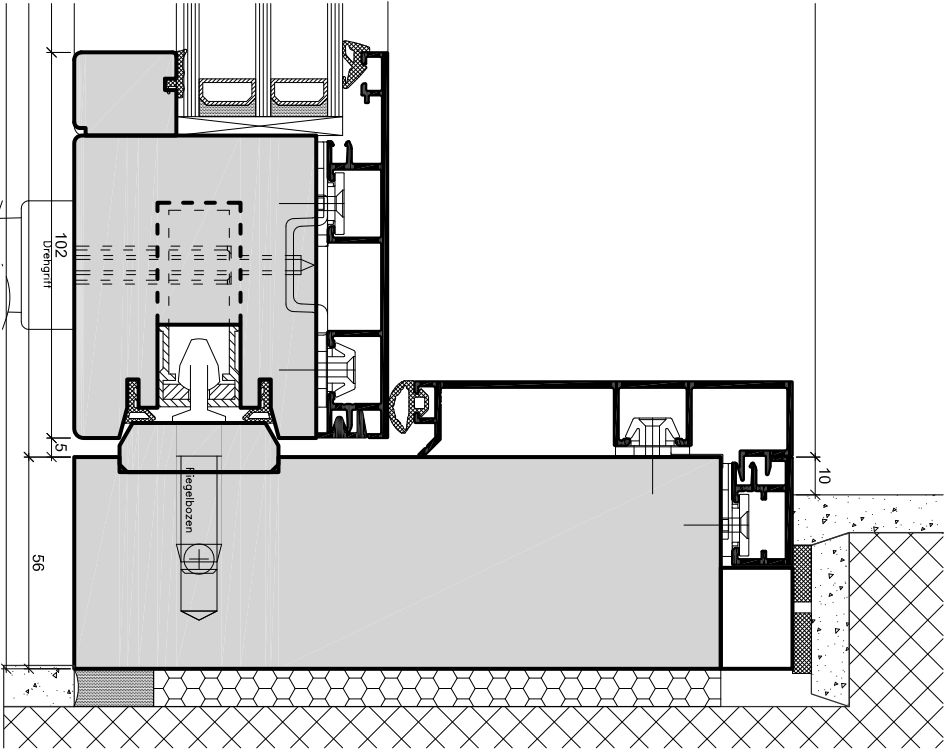
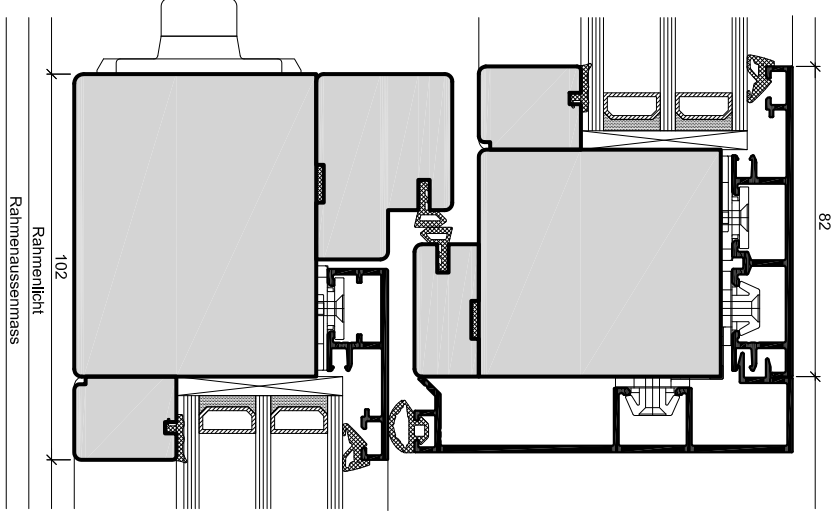
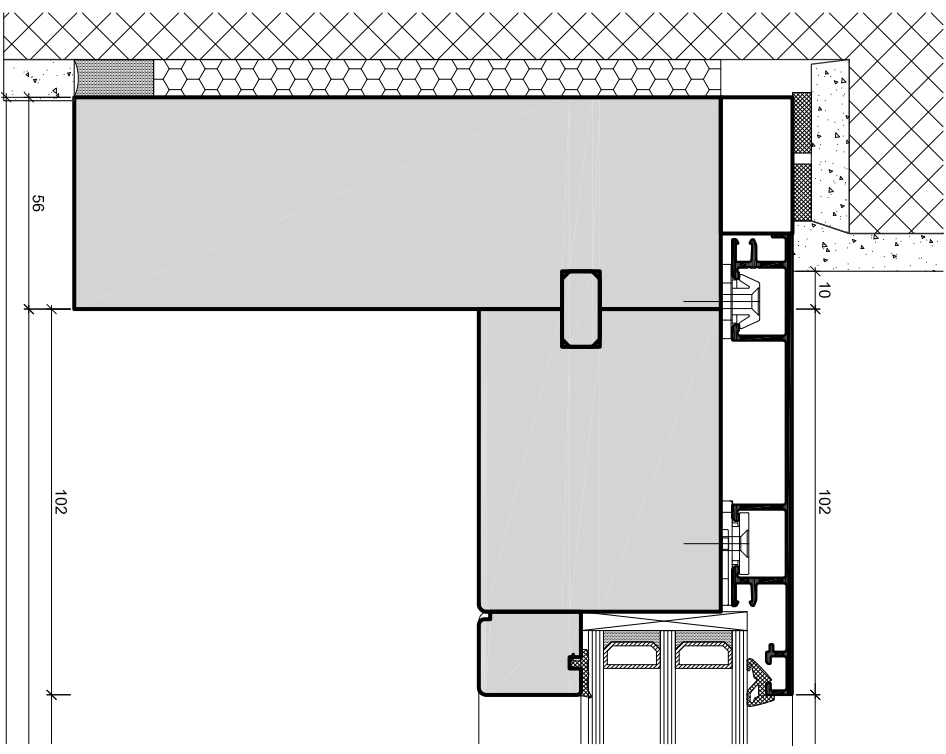

Fax: 041 750 40 94

Mail: info@fenster-nussbaumer.ch

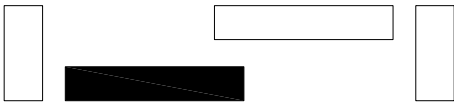
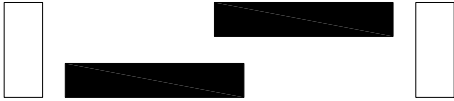

Sämtliche Zeichnungen dürfen nur mit schriftlicher Einwilligung durch die Nussbaumer Fensterbau AG an Dritte weitergegeben werden.

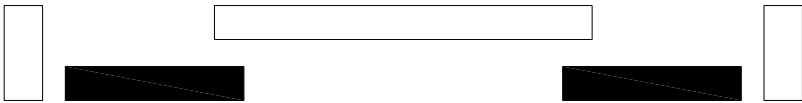

Grundriss	Schema
	A
	D
	G1/G2
	C
	F
	K